



# K-U Campus Series

The School Security & Safety Solution





# The Prevalence of **School Violence**

School violence seems to be a part of the news we hear from time to time. It isn't anything new and have been happening around the community. There have been countless numbers of stabbings, shootings, fights and other types of violence in schools over the years, and a lot of people have been hurt or killed in these incidents.

School security is a unique challenge that demands innovative solutions and is a top priority for Klacci. Our goal is to prevent future tragedies, while ensuring the safety of children and faculty and providing peace of mind to parents.





According to data\* from the United States Centers for Disease Control and Prevention (CDC):

- 1 in 5 high school students in the United States reported being bullied on school property in 2016.
- Homicide is the 3rd leading cause of death for young people ages 10-24.
- Youth violence is costly. Youth homicides and nonfatal physical assault-related injury cost billions of dollars each year.

Parents need to have peace of mind knowing that their children are protected while they are in school. At Klacci, we believe that it is our job to work together to keep all children as safe as possible. It is also our responsibility to do what we can to make sure that schools are safe places for parents to send their children.

\* Data source quoted from the United States Centers for Disease Control and Prevention (CDC) used for youth violence prevention.



# K-U Campus Series

The Ideal Security  
and Safety Solution  
for Schools







Every school is unique when considering which security measures to put into place. No two schools have the same campus size, numbers of room, building layout and design. Budget is also an essential factor. Klacci's K-U Campus Series offers a flexible solution for school administrations to choose that balances the available budget resources with the safety needs in the environment.

The K-U Campus Series, a lockdown and access control solution using Klacci's comprehensive heavy-duty commercial products, all meet the ANSI/BHMA Grade 1 or Grade 2 strength requirements with UL294, UL60950, FCC Part 15 B&C.

The solution provides a wide range of options for both faculty members and first-line responders to be able to react to different threat levels. Occasionally, an immediate lockdown is needed. Often a partial lockdown based upon suspicious activities is best, and at times, a total evacuation is required during an emergency situation. The K-U Campus Series provides options to meet every circumstance.

# Establish Guidelines and Let Klacci Do the Rest

Each school establishes guidelines for what actions would be necessary for each security event. A security event may be internal such as school violence or an active shooter. It may also be an external threat such as a pandemic outbreak, a violent crime, or a threat near the school or at a distance. Each security event has its own unique challenges and may evolve quickly accelerating from "normal" to "total lockdown".

Examples of emergency events and possible responsive actions may include:

Event	Prevent Entry - Completely	Prevent Entry - Partially	Evacuation
Power Failure			×
Earthquake			×
Fire			×
Bomb Threat			×
Hostage Event		×	
Active Shooter	×		
Panic Alarm	×		

**Code GREEN**

Evacuation of Building

**Code YELLOW**

Prevent Entry in part - Hold and secure

**Code RED**

Prevent Entry Completely - Out of sight and no movement

## The Central Parts of the System

### Emergency Card - The Core of the Solutions



The authorized card triggers and reverses a complete lockdown by inserting and removing the card from the holder. The ability to integrate the Emergency Card with other security options ensures that the system is customized for budget, building layout and security risk assessment.

### Centralized Security System



The K-U Campus Series is PC and smart device compatible, monitoring the real-time status of all access points on the premises, including responsive action triggers to lock all areas or specified areas in seconds.

### Fob



Use the Fob to easily secure or release access to one or multiple nearby doors during a panic situation.

### Shooter Detector

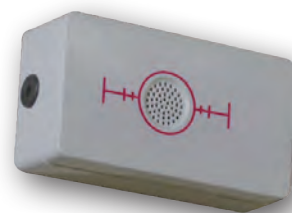

Automatically and immediately secures access to a nearby area where gunshot is detected.

## Manual Operations



No hard wiring. Manually engage locking mechanism with an optional visual indication which shows the status of each individual lock. Refer to page 27~28.



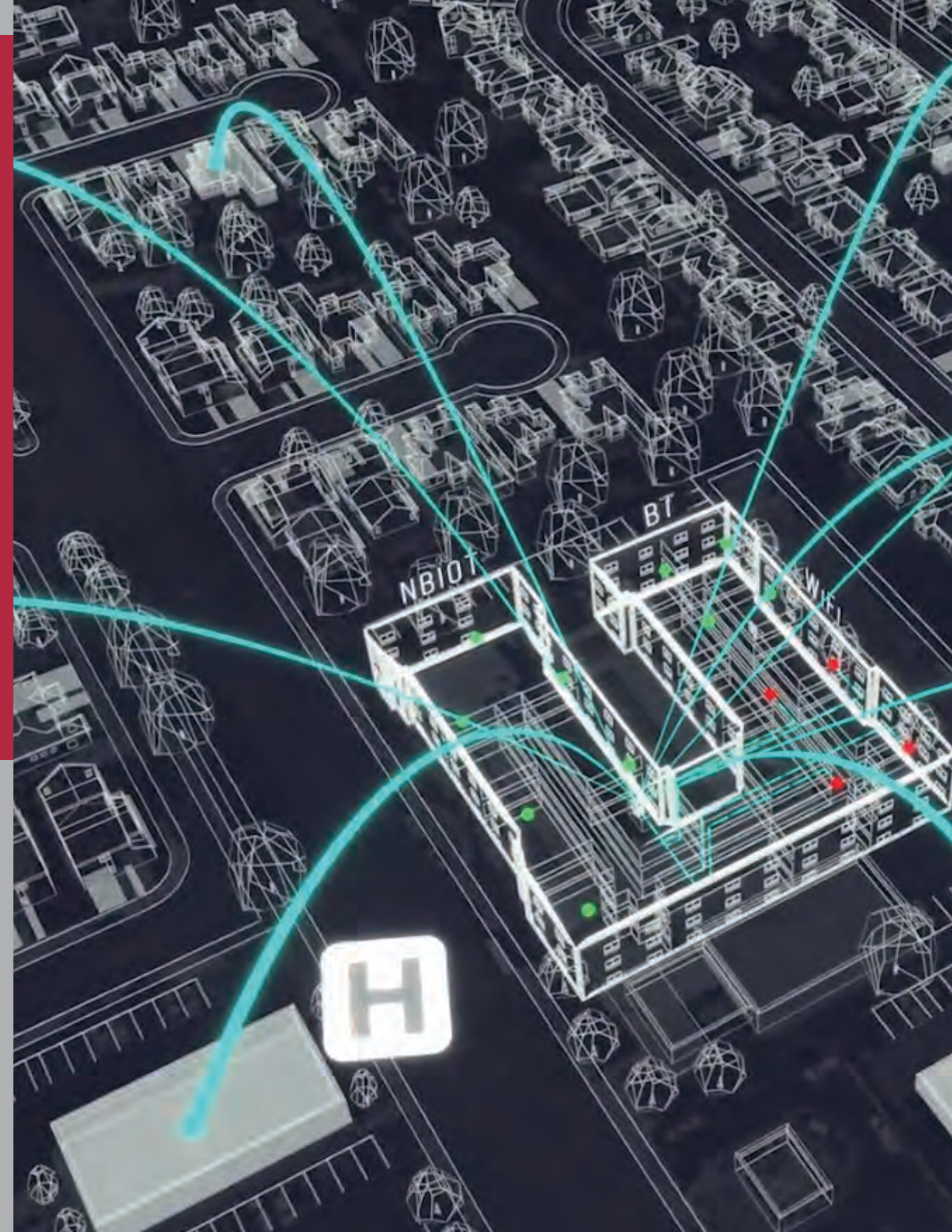



# School Security Solutions

- ✓ Removing the authorized emergency card to set off lockdown mode from principal's office or security control center. (Inserting the card disables lockdown mode).
- ✓ PC/Smart Device features:
  - The registered administrator assigns or revokes authorization to individual user or door lock via the system.
  - Users may control the locked doors and initiate responsive actions via smart devices based on their assigned authority.
  - Both system administrator and users could control the locked/unlocked doors depending on the emergency.
- ✓ Automatically informs the police.
- ✓ Once triggered, it automatically initiates a fire alarm and informs the fire department.
- ✓ Shooter detectors automatically lock multiple or individual locks when a gunshot is detected. Alerts are sent to the principal or security office with no human action required.

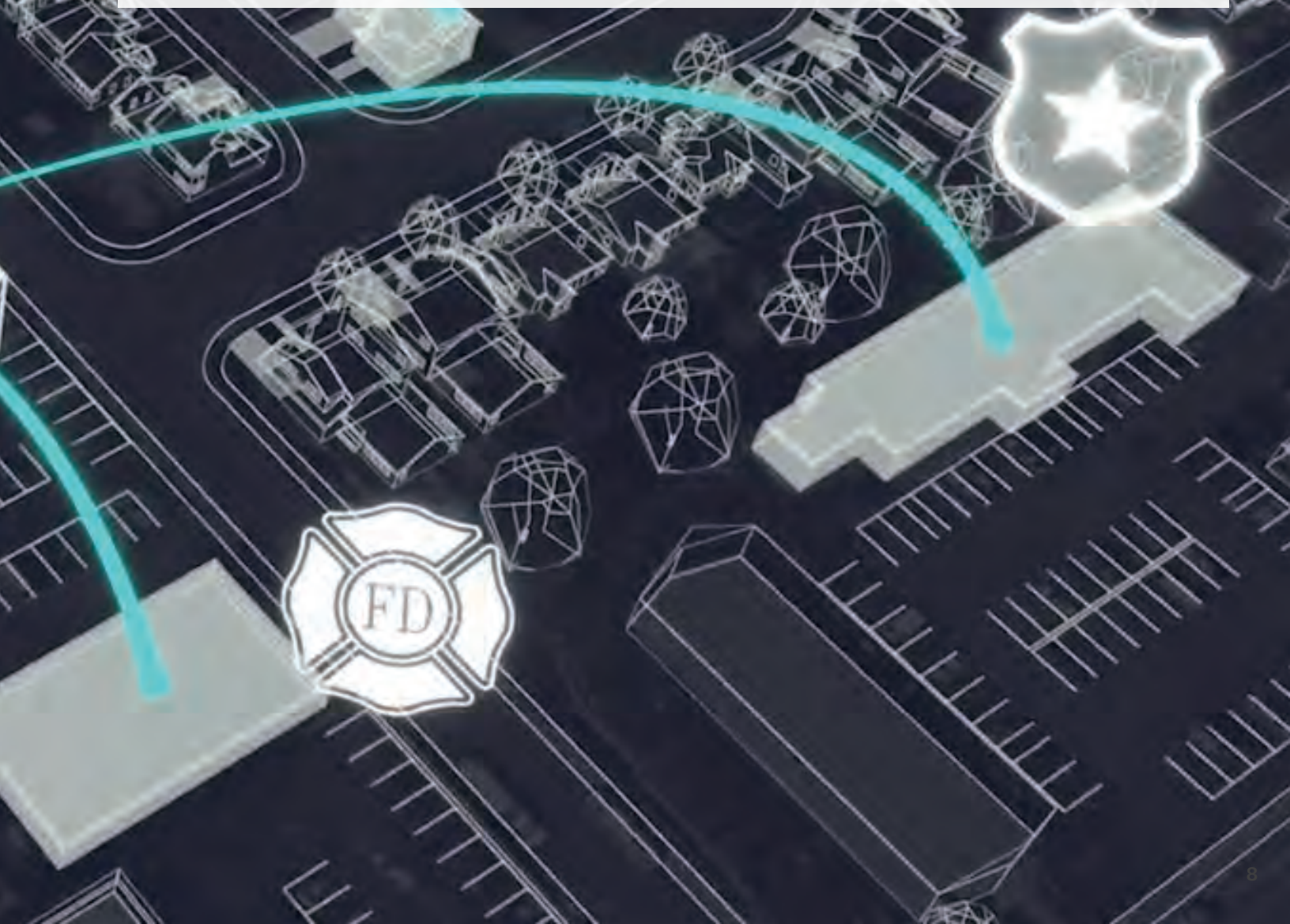

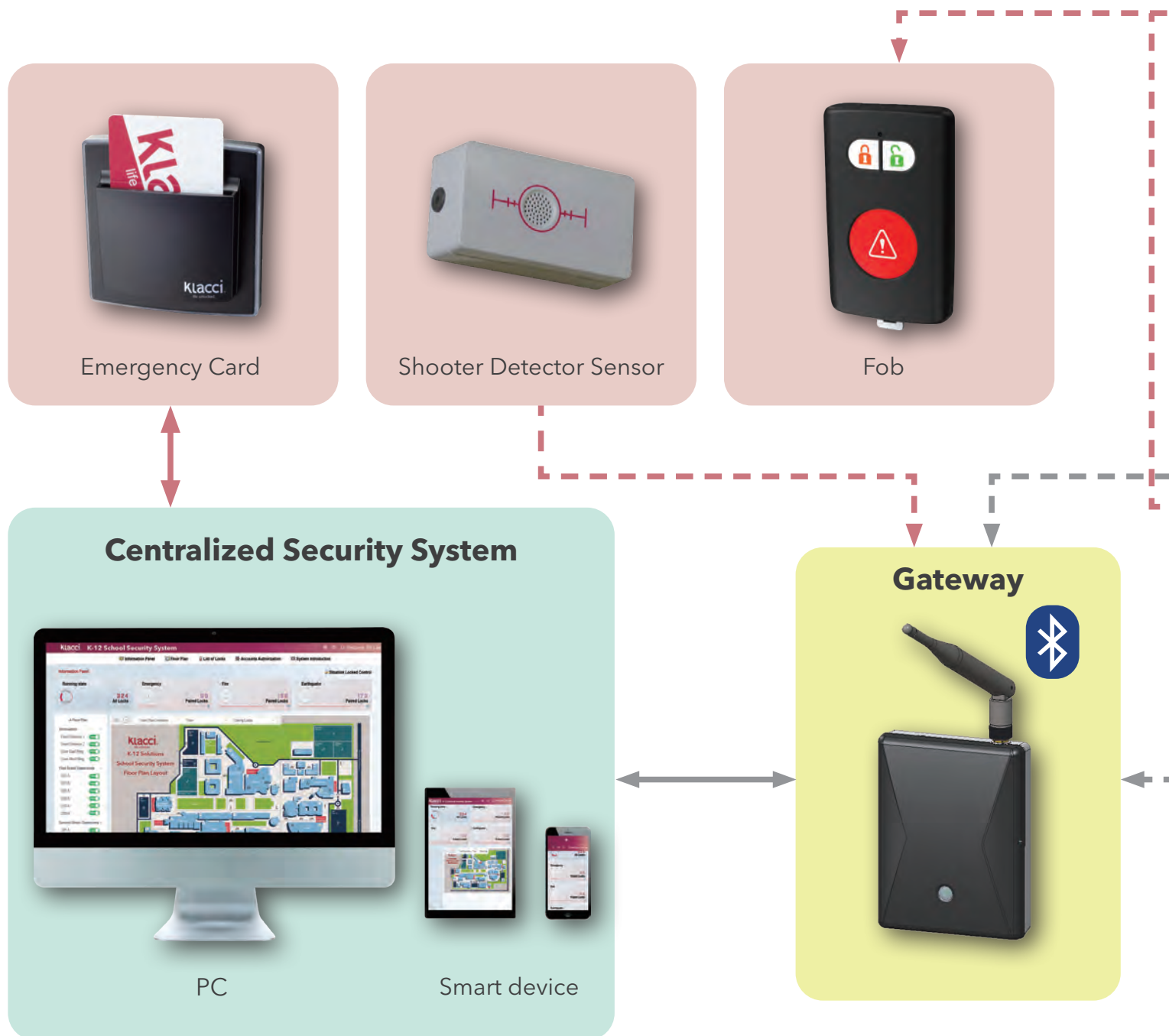

# How the Solution Works

The diagram illustrates how Klacci's complete School Security Solution for both daily management and emergency lockdown integrates through the Centralized Real-time System, Emergency Card, Fob, and other devices. Door locks are available as either battery powered, or low voltage powered versions.

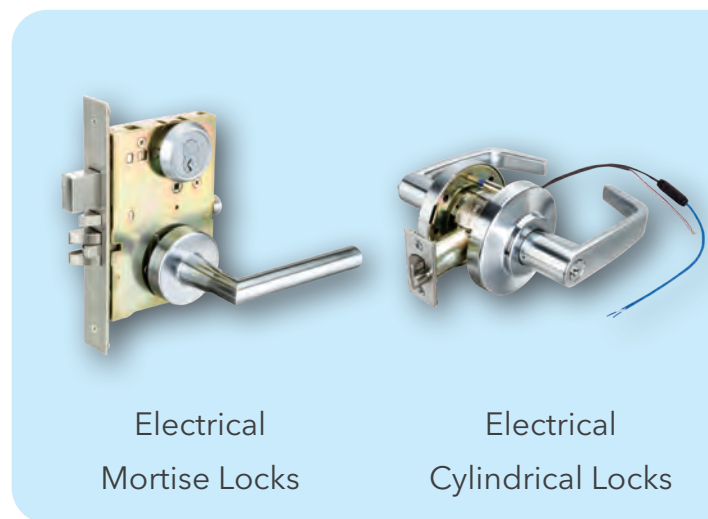





\* Estimated 3-year battery life with 4 AA alkaline batteries.

# The Centralized Security System



In a panic situation, there is no room for mistakes and reactions must be enforced in a matter of seconds. The K-U Campus Series gives you the most visual and direct management over panic situations. You have total control of the system even during life-threatening situations.

1. K-U Campus Series monitors the premises and instantly carries out lockdown procedures and reacts to emergencies such as fire, panic alarm, or active shooter.
2. The system can be used to secure an individual entrance, groups of exits in a designated area at once, or trigger a complete lockdown.
3. The Floor Map layout display can be customized to the actual surroundings for real-time monitoring and to control each access point.
4. The system automatically updates and diagnoses the connection to synchronize the status (locked/unlocked) of each lock.
5. The Emergency Card, as an integral part of the K-U Campus Series overrides commands from other devices to physically initiate a complete lockdown.
6. An available mobile phone app and remote fob gives faculty members or authorized staff the ability to react to emergencies.



# Navigating the System

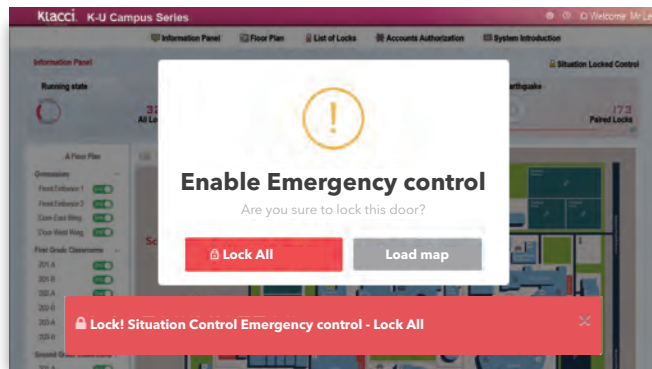

## Initiating a lockdown

Based on the emergency, clicking on the corresponding responsive button will prompt an alert and confirmation before initiating procedures.

A real-time message displays the current status during the lockdown.

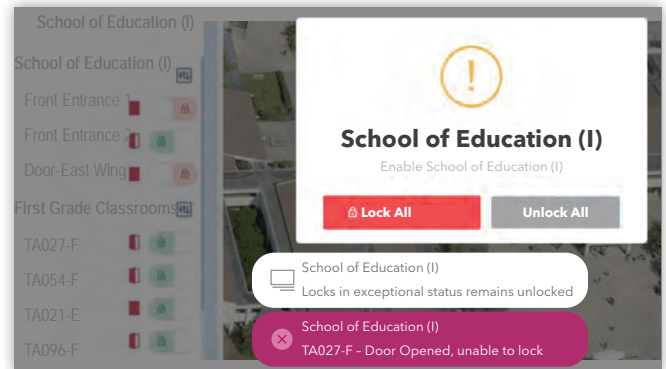

## Door Position Detection

The system automatically detects that doors are properly closed and locked during lockdown mode.



## Planning and Assigning Authorizations

Individual areas can be configured and added from the floor plan overview, setting up authorized devices or remote fobs which can lock access in that area and show status during the lockdown.



## Real-time Surveillance

A video surveillance system can be integrated into the system. Monitoring the premises is effortless from the floor plan overview.



# Emergency Card

Installs in a designated area, such as the principal's office, the security center or with personnel having the highest authority in determining a lockdown.

The Emergency Card serves as the master to initiate and override commands from all other devices.

## Features

- Removing the Emergency Card from the card holder will initiate a complete lockdown in 3 seconds.
- Replacing the Emergency Card in the holder followed by passcode entry or biometric verifications release all access points and reverts the system back to stand-by status.

## Specifications

Standard	<ul style="list-style-type: none"><li>• Conforms to ISO/IEC 14443-A standard.</li></ul>
Card Type	<ul style="list-style-type: none"><li>• Mifare® Classic, Mifare® DESFire, Mifare® Plus.</li></ul>
Frequency	<ul style="list-style-type: none"><li>• 13.56 MHz.</li></ul>
Material	<ul style="list-style-type: none"><li>• PVC.</li></ul>
Size	<ul style="list-style-type: none"><li>• 3-3/8" × 2-1/8" × 1/32" (85.6mm × 54mm × 0.8mm).</li></ul>



# Fob

Certain situations simply cannot wait for the central office to take the necessary actions against the threat. The fob is designed for mobility and responsive reaction to protect students and teachers. When securing an individual door or groups of exits in one designated area is required, simply pressing buttons on the fob and transmitting the command via a secure 433 MHz wireless network to the Klaccis's K-U Campus Series and gateways initiates the response.



## Features

- Three Buttons: Lock/Unlock and Lockdown(with LED).
- Range: 75 ft. indoors (typical), outdoor 25 ft.
- Visual Indicators: LED indication under buttons.
- Initiate Code RED Emergency Lockdown: Press and hold for 3 second to initiate lockdown; A lockdown cannot be canceled via the fob; it must be overridden from the central system once initiated.
- Lock / Unlock: Press the button to secure or release the door.
- A Scalable Solution: The fob can lock down a single door or set of doors.

## Specifications

<b>Wireless Communications</b>	• 433 MHz; Range of 75 ft. indoors (typical), outdoor 25 ft.
--------------------------------	--

<b>Buttons</b>	• 3 button fob.
----------------	-----------------

<b>Lockdown button</b>	• Press and hold for 3 second to initiate fob will flash when it is working.
------------------------	--

<b>Lock Door button</b>	• Press the button to lock the door.
-------------------------	--------------------------------------

<b>Unlock Door button</b>	• Press the button to open the door.
---------------------------	--------------------------------------

<b>Capability</b>	• Configurable to lock single door, set of doors or entire system.
-------------------	--

<b>Dimensions</b>	• 1.4 x 2.3 inches.
-------------------	---------------------

<b>Weight</b>	• 0.53 oz.
---------------	------------

<b>Code Compliance</b>	• FCC Part 15 B&C.
------------------------	--------------------

<b>Material</b>	• Polycarbonate. • Protective button cover to prevent false alarms.
-----------------	--

<b>Battery</b>	• Standard 3V CR2032 battery. • Up to 3 year battery life.
----------------	---

<b>Color</b>	• Black.
--------------	----------



# Shooter Detector

When every second counts and there is no chance for a second thought, shooter detectors are installed onsite throughout the building to automatically secure doors or trigger responsive actions. The automatic operation greatly reduces response time and errors made during an emergency.

Used with the K-U Campus Series, shooter detectors can locate and follow the shooter remotely. The trace of the threat is in complete control.

## Features

- Does not require human action, which means faster and more accurate decisions.
- Automatically triggers lockdown, secures doors, sends a broadcast or mass notification, and calls responding units (available depending on the setting).
- Installing multiple shooter detectors allows the K-U Campus Series to track the shooter.



# Gateway



The Bluetooth technology is designed to make connectivity of data among multiple points over long distances in harsh environments. The Klaccki Gateway is designed for the K-U Campus Series to effectively communicate with multiple devices on the field for long range coverage through Bluetooth technology. Information can be exchanged consistently and responsively.

What this mean to you is a reliable connection and timely responses for command entry between the administrator and the field personnel. You can be confident that there are no dark spots in your building scanning for coverage when you need it. Rest assured that your school is ready to respond in any emergency situation.

## Specifications

Power Supply	<ul style="list-style-type: none"><li>• 12~24Vdc , 330~100mA(terminal).</li><li>• 12~24Vdc, 330~100mA power adapter.</li><li>• PoE supported IEEE802.3af ,60mA (Class 4/Max Power 12.95W ).</li></ul>
Ethernet Standard	<ul style="list-style-type: none"><li>• 10 BASE-T/100 BASE-TX.</li></ul>
Frequency Ragnge	<ul style="list-style-type: none"><li>• 2450~2480 MHz (Bluetooth).</li><li>• RF Standard: IEEE 802.15.4.</li></ul>
Operating Temperature	<ul style="list-style-type: none"><li>• 0~49 °C.</li></ul>
Operating Humidity	<ul style="list-style-type: none"><li>• 85%.</li></ul>
Indoor Radio Range	<ul style="list-style-type: none"><li>• 10~15m (30'~50').</li></ul>
Cable requirements	<ul style="list-style-type: none"><li>• Ethernet: UTP CAT5e.</li><li>• RS-485: Generic twisted pair wire.</li></ul>
Certification/Compliance	<ul style="list-style-type: none"><li>• UL294, FCC Part 15, Industry Canada(IC), RoHS, PoE compliant to IEEE802.3af/at.</li></ul>
Dimensions	<ul style="list-style-type: none"><li>• 110mm x 85mm x 28.5mm (H x W x D)</li></ul>
Tamper Switch	<ul style="list-style-type: none"><li>• Unauthorized dismantle of the device will transmit alert to the system.</li></ul>
System interface	<ul style="list-style-type: none"><li>• Ethernet to IP host.</li><li>• RS-485 to Repeater/lock.</li></ul>

# All the Hardware You Need for Your School Security Solution

Klacci offers the most extensive selection and the toughest hardware to employ with the K-U Campus Series.



**Kii Assistant Series  
Reader**



**LF Series  
Electric Cylindrical Lock**



**M/M1 Series  
Electric Mortise Lock**



**1000/2000/30 Series  
Electric Exit Device**





**iF Series**  
**Cylindrical Locks**



**iF Series**  
**Mortise Locks**



**Kii Assistant Series**  
**Cylindrical Locks**



**Kii Assistant Series**  
**Mortise Locks**



**PO Series**  
**Door Operators**



**ES Series**  
**Electric Strikes**



**Electric Bolt**

# Electric Cylindrical Lock

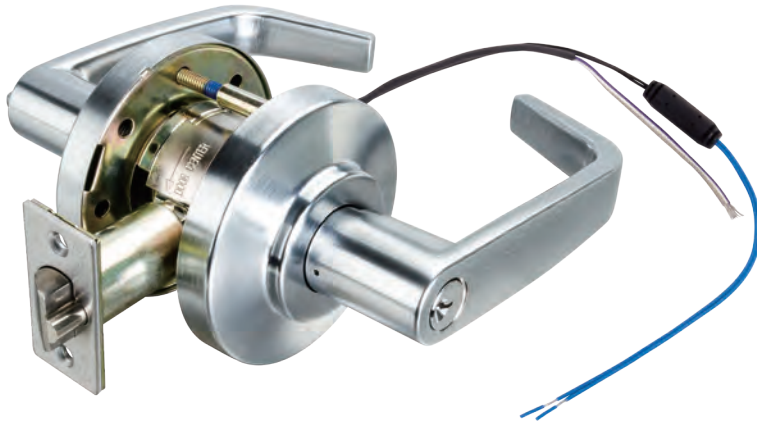

**LF Series cylindrical locks are also available for electrical options for access control systems in high-security applications.**

## Options

### RX - Request to Exit

The RX feature is used to signal an opening and is equipped with one internal SPDT switch that monitors the turning of the lever. The device can be connected to a security console or may be used as a single door alarm when used with a horn and power supply.

### EL - Electrically Locked (Fail Safe)

Fail Safe locks require power to lock. In the event of a power outage the door will automatically unlock, thus ensuring a safe egress during emergency situations.

### EU - Electrically Unlocked (Fail Secure)

Fail Secure locks require power to unlock. In the event of a power outage the door will automatically lock, thus preventing access and protecting all assets within it. This feature is not permitted on fire doors.

## Electrical requirements

### Electrified functions - EU and EL

- 24 Volts AC/DC +/- 10% Operating current 0.145 Amp.
- 12 Volts AC/DC +/- 10% Operating current 0.293 Amp.
- \* All solenoids are continuous duty.

### RX - Functions

- Voltage 250 VAC. Current rating 1 Amp. Wire leads 22 AWG.

The 3-wire utilizes a UL recognized SPDT switch providing a choice of:

- \* For normally closed operation use the white (COM.) and gray wires.
- \* For normally open operation use the white (COM.) and purple wires.



# Electric Mortise Lock



**The most robust lock platform for maximum security requirements.**

## Options

### SS - Signal Switch

Detection of auxiliary latchbolt status through SPDT switch.

### EL/EU - M1105EL (Fail Safe) or M1205EU (Fail Secure)

Voltage options 12 or 24 VDC (Must be specified when ordering).

### RX - Request to Exit

Micro switch positioned inside the lock case monitors the lever/knob position.

### LM - Latchbolt Monitoring

Latchbolt monitoring is an SPDT switch which monitors the latchbolt position.

## Electrical Specifications:

Solenoid current: 24 VDC, 0.33 Amp.  
12 VDC, 0.66 Amp.

Switch rate: 24 VDC, 2 Amp SPDT.  
SPDT (Single Pole, Double Throw)

# Electric Exit Device



1000 Series



2000 Series

## **ELR** (Electrical Dogging)

### Electric Latch Retraction

#### **Access and exit point control and monitoring.**

ELR provides the ability to remotely retract the latchbolt. Continuous duty solenoid can retract latchbolts under conditions of unlatching or continually dogging. The ELR option can be applied with card readers, toggles or key switches, push buttons and fire alarm systems. PS100 power supply is required for the use of ELR option.

- UL/cUL Listed for Panic and Fire for Class 2 Circuitry.
- ELR is available with Manual Flat/Hex Key for Panic Exit Devices.

#### **Solenoid Specifications**

- Current Pulse (0.3 seconds):  
24 VDC, 16 Amp.
- Continuous: 24 VDC, 0.25 Amp  
Requires PS100 Power Supply.



# Electric Mortise Lock Exit Device

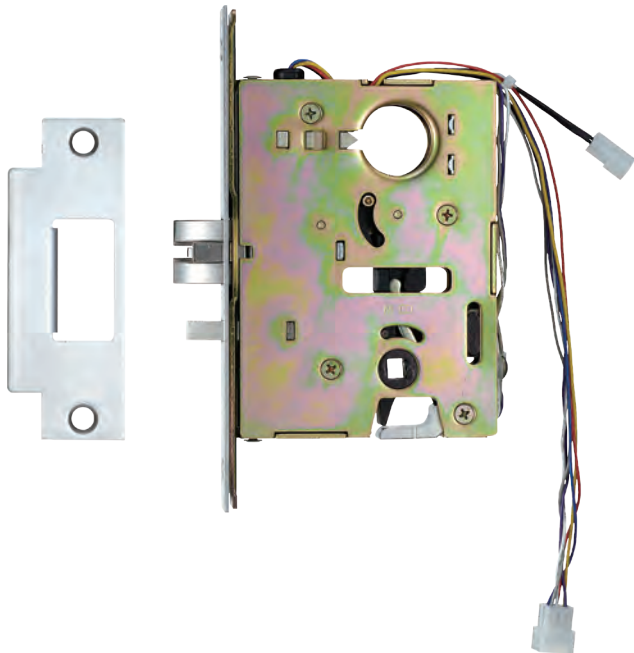

**The Electric Mortise Exit Devices (E1400) can control entry to remote locking and unlocking the outside trim or an automatic fire alarm system.**

The remote has two main functions:

1. To monitor the lock or unlock status through the SPDT signal.
2. To monitor the auxiliary latchbolt status through the SPDT signal.

The outside trim cylinder can retract the latchbolt as a night latch function.

**The Electric Mortise Exit Device is available with the following electrical options:**

- E1400 - Electric lock/unlock with switches to monitor the outside trim (locked or unlocked) and to monitor the latchbolt.
- SS1400 - Latchbolt and trim locked or unlocked monitoring.

## Wiring Diagram

### E Mortise Function

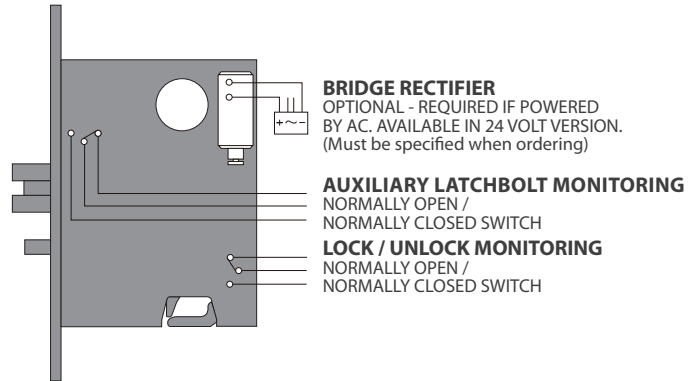

### SS Mortise Function

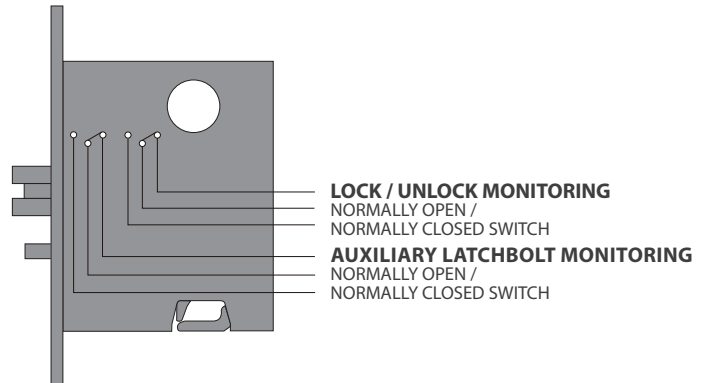

## Mortise case Only:

E7000 - Mortise case for E1400 model.

SS7000 - Mortise case for SS1400 model.

## Electrical Ratings:

The Mortise Lock is furnished standard as Fail Secure (FSE). When power is off, the trim is locked. Power is applied to unlock the trim.

It may be field converted to a Fail Safe (FS) mode. (FS) - power is applied to lock the trim.

- Solenoid current: 24 VDC, 0.25 Amp.  
12 VDC, 0.5 Amp.
- Switch rate: 24 VDC, 2 Amp SPDT.  
SPDT (Single Pole, Double Throw).

# Exit Device Electric Trim

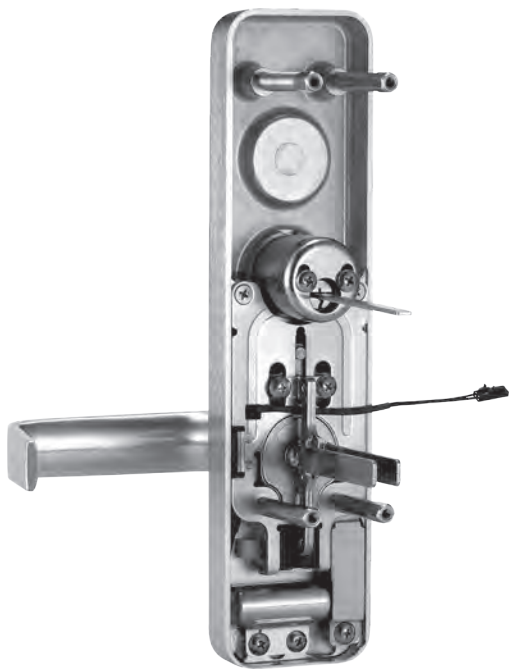

## E300 Series



**Electrified trim with integrated lock/unlock option. Trim can be used for all 1000 Series models. Available as fail-secure or fail-safe.**

Specify suffix FSE (Fail-Secure) or FS (Fail-Safe) following trim designation.

### Electrical Ratings

Solenoid current: 24 VDC, 0.25 Amp.  
12 VDC, 0.5 Amp.

## Electrical Trim - E300 Series

				
Operation	Electrified trim with integrated lock/unlock option (Night Latch Key Retracts Latchbolt)		Electrified trim with integrated lock/unlock option (no Cylinder)	
Trim No.	E309R	E309M	E314R	E314M
Device No.	1100/1105		1100/1105	
	1200		1200	
	1300		1300	
		1400		1400
	1500		1500	
Cylinder Type	RIM	Mortise		



# Electrical Strike

## Converts non-electric locking devices into electrified controlled access points.



- UL/ULC compliant for 3-hour fire Rating (fail secure only).
- UL 1034 compliant for burglary-resistant electric locking mechanisms.
- UL 294 compliant for access control system units (7th edition).
- ANSI/BHMA A156.31 Grade 1 Electric Strikes Standard.
- Static strength 1,500 lbs.
- Dynamic strength 70 ft-lbs.
- Endurance 500,000 cycles.

### Frame Application    **Electrical (continuous duty)**

- |             |                    |
|-------------|--------------------|
| • Metal.    | • 12 VDC, 0.26Amp. |
| • Wood.     | • 24 VDC, 0.13Amp. |
| • Aluminum. |                    |



## ES100

- Field selectable fail secure / fail safe.
- Field adjustable integrated shim.
- Non-handed.
- Accommodates cylindrical and mortise locks.
- Accommodates 1/2"~1-3/4" (12.7mm ~19.1mm) latch projection.
- Accommodates 1" (25.4mm) deadbolt.



## ES200

- Field selectable fail secure / fail safe.
- Surface mounted, no frame cutting required.
- Non-handed.
- Accommodates Rim Exit Devices with a Pullman latch.
- Accommodates 1/2"~1-3/4" (12.7mm~19.1mm) latch projection.

# Power Supply



## PS100

**The PS100 Power Supply is applicable for wide range of electrical products and the School Security System.**

There is an option to add a key to lock the enclosure. The battery has two hours of backup power at full load during an A.C. power failure. Batteries will automatically recharge once power is restored. Fire alarm provides an input for a normally closed fire alarm contact. When the fire alarm contact is "open", the power to locks or other components are removed. Restoring power is field selectable (automatic or manual).

### Certification

UL/cUL listed as a power supply unit class 2, UL294, UL1034 and ULC-S318 requirements.

### Specifications

- UL/cUL listed for Class 2 output.
- LED indicators for AC input, DC output and battery backup status.
- The power supply can control up to (4) delayed egress exit devices.

### Optional Circuit Cards

The PS100 Series is available with several optional circuit cards to provide system flexibility. The power supply will accept one or a combination of any two cards.

- Circuit breakers provide protection for motherboard.
- Standard input options:
  - 120 VAC, 1.0 Amp or
  - 240 VAC, 0.5 Amp.
- Output power:
  - 24 VDC, 2 Amp or
  - 12 VDC, 2 Amp.
- Power supply box:
  - 10" high × 12-1/2" wide × 5" deep (254mm × 318mm × 127mm), gray with a hinged cover and constructed of heavy 20 gauge steel.
- 3 options:
  - (1) Key lock.
  - (2) Fire alarm.
  - (3) Battery backup (2 hrs.) during AC power failure.

### Maximum wire run:

- 75 ft. with 14 gauge wire and 28 gauge power transfer.
- 100 ft. with 14 gauge wire and 24 gauge power transfer.
- 200 ft. with 12 gauge wire and 24 gauge power transfer.

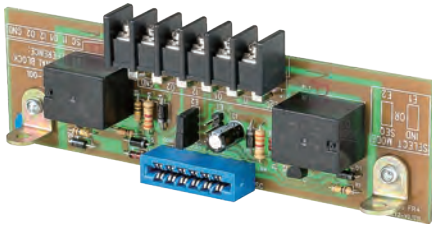

**100-2 Two (2) Zone Controller Board**

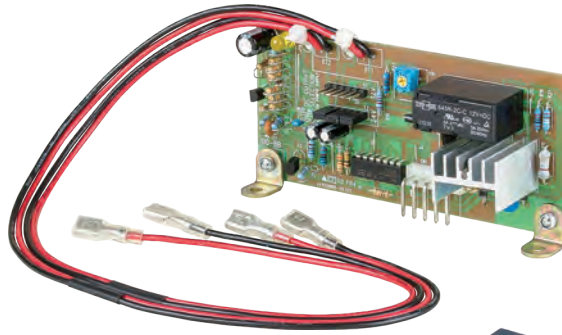

**100-FA Fire Alarm**

**100-BB Battery Backup**

## Power Transfer - EPT

EPT-1 Power Transfer comes with steel housing and flexible tube. A secure and inconspicuous channel brings power from the frame to the door. A narrow, shallow channel easily mortises into door edges. The EPT-1 Power Transfer accepts up to 3/8" (9.5mm) diameter wire bundle and accommodates doors that swing open 120 degrees. The unit is concealed when the door is closed and is suitable for wood, aluminum, or steel door applications.

EPT-2 Armored flex conduit. Accepts up to 1/4" (6.4mm) diameter wire bundle.



**EPT-1**

**EPT-2**

## Power Adapter

**The power adapter can be used for supplying power to the detectors, sensors, devices, electric locks, readers, or other electrical devices.**



### Electrical Ratings

Input : 100~240VAC, 50~60HZ.

Output : 24VDC, 2.5A.



# Manual Operations

When individual door security is needed without remote or centralized monitoring, manual operation is the best solution, protected by Klacci's robust door locks and hardware.

- An economic budgetary solution that won't compromise your security
- Klacci offers a wide range of mechanical and standalone electrical lock and hardware selection including cylindrical locks, mortise locks, deadbolt locks, and exit devices.
- There is an option to include a visual indicator on the devices, so faculty are confident they are protected.
- No complex wiring is needed for installation and no centralized service maintenance is required.



**M/M1 Series Mortise Lock with interior side indicator**



**LF Series Cylindrical Lock with "LOCK" mark inside rose**



**1000 Series Exit Device with interior side indicator**



# About Klacci

Klacci, a registered brand of the world-renowned I-TEK Company, provides the commercial and residential markets with second to none access control and lock products. The company offers an extensive selection of mechanical, electrical, and biometric locks that reflect the demands of today's modern lifestyle.

Klacci's drive for design excellence and innovation is only matched by I-TEK's manufacturing expertise which spans more than five decades.

## Safety and Security

Klacci, a registered member of the Builders Hardware Manufacturers Association (BHMA), possesses an Intertek certified and ISO17025 compliance laboratory within its facility, one of the few in Asia.

Before our products are sold and installed, our laboratory performs various and rigorous testing procedures to make sure all our products meet and exceed the minimum requirements that are specified and meet the respective standards of ANSI/BHMA, UL, ASTM, etc.

## Certificates

All products are continuously certified under the Follow-up Service Program to meet the most updated mechanical lock and electrical access control standards. The UL10C Standard for Positive Pressure Fire Tests listing of our products is part of Klacci's commitment to life safety and security.





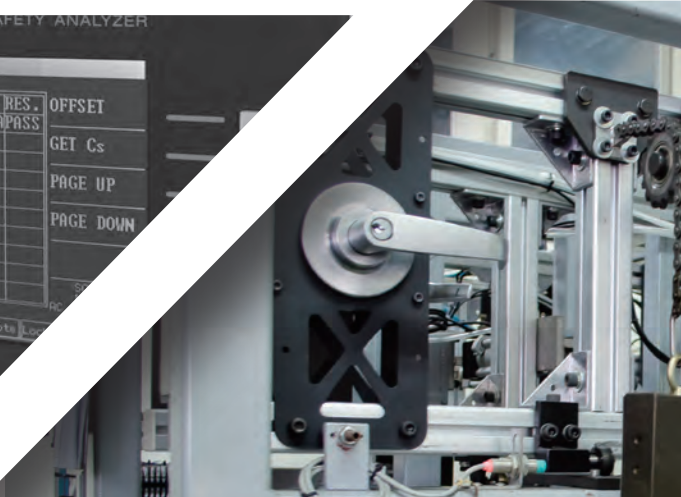
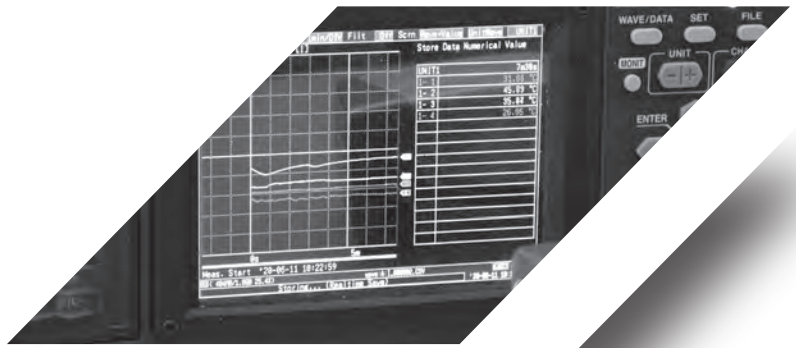

**klacci**<sup>®</sup>  
life unlocked.



[www.klacci.com](http://www.klacci.com)

#### Headquarters and Operation Office

**I-TEK Metal Manufacturing Co., Ltd.**

📍 18 Gungye 3rd Road, Annan,  
Tainan 70955, Taiwan.



**T** 886 6 3840722

**F** 886 6 3840715

**E** [sd.klacci@gmail.com](mailto:sd.klacci@gmail.com)

[sd@klacci.com](mailto:sd@klacci.com)

[sd@iteklock.com.tw](mailto:sd@iteklock.com.tw)

#### Global Office

**KLACCI Inc.**

📍 California, USA

📍 Nevada, USA

**T** +1 (720) 675-5677

**E** [sd@klacci.com](mailto:sd@klacci.com)

[sd.klacci@gmail.com](mailto:sd.klacci@gmail.com)